

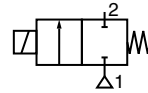

MICRO SOLENOID VALVE

diaphragm mechanism, fluid isolation
pad-mounting body

NC



2/2
Series
282

FEATURES

- Miniature solenoid valves for medical and gas analysers and biotechnology equipment
- Designed to control acids, bases and analytical reagents
- Hermetic separation of control mechanism and fluid:
 - Particulate contamination caused by friction of moving parts is excluded
 - Reliable operation in applications with highly aggressive fluids is ensured
- Easy-to-flush internal cavity and good self-draining capability
- Low dead volume
- Low power consumption
- Easy installation

GENERAL

| | |
|-----------------------|--------------------------------|
| Differential pressure | 0 to +0,5 bar [1 bar =100 kPa] |
| Maximum viscosity | 20 cSt (mm ² /s) |
| Response time | < 20 ms |
| Dead volume | < 10 µl |

| fluids (*) | temperature range (TS) | seal materials (*) |
|--------------------------------------|------------------------|---------------------------|
| liquids or gases (filtered 50 µm) | +10°C to + 40°C | FFPM (perfluoroelastomer) |

MATERIALS IN CONTACT WITH FLUID

(*) Ensure that the compatibility of the fluids in contact with the materials is verified

| | |
|-----------|------|
| Body | PEEK |
| Diaphragm | FFPM |
| Seals | FPM |

OTHERS MATERIALS

| | |
|----------------|-----------------|
| Internal parts | Stainless steel |
|----------------|-----------------|

ELECTRICAL CHARACTERISTICS

| | |
|---------------------------------|--------------------------|
| Coil insulation class | F |
| Connection | Cable ends, length 0,3 m |
| Electrical safety | IEC 335 |
| Electrical enclosure protection | IP40 (EN 60529) |
| Standard voltages | DC (=) : 12V - 24V |

| prefix option | power ratings | | | operator ambient temperature range (TS) (C°) | replacement coil | type ⁽¹⁾ |
|---------------|---------------------|--------------------------|------------------|---|------------------|---------------------|
| | inrush ~ (VA) | holding ~ (VA) (W) | cold = (W) | | | |
| L | - | - | - | 1 | +10 to + 40 | - - 01 |

⁽¹⁾ Refer to the dimensional drawings on the following page.

SPECIFICATIONS

| pipe size | orifice size (mm) | flow coefficient Kv | | min. | operating pressure differential (bar) | | power coil (W) | catalogue number |
|-----------------------------|----------------------|---------------------|---------|------|---------------------------------------|--------------------|----------------|-------------------|
| | | (m ³ /h) | (l/min) | | max. (PS) | liquids, gases (*) | | cable ends |
| | | | | | | | | pad-mounting body |
| | | | | | | | | = |
| NC - Normally closed | | | | | | | | |
| pad mounting | 0,5 | 0,0066 | 0,11 | 0 | 0,5 | 1 | | LS282A010 |

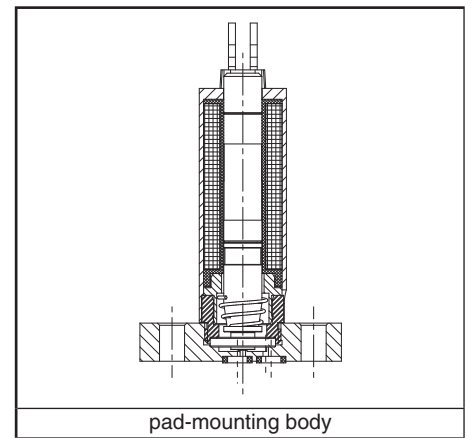

OPTIONS

• Valves can also be supplied with FPM (fluoroelastomer) and EPDM (ethylene-propylene) seals and diaphragm. Contact us

INSTALLATION

• The solenoid valves can be mounted in any position without affecting operation

DIMENSIONS (mm), WEIGHT (kg) 

TYPE 01
 Prefix "L" solenoid
 IEC 335 / with cable ends, length 0,3 m
 IP40
 Weight: 0,006
LS282A010



ORDERING EXAMPLES:

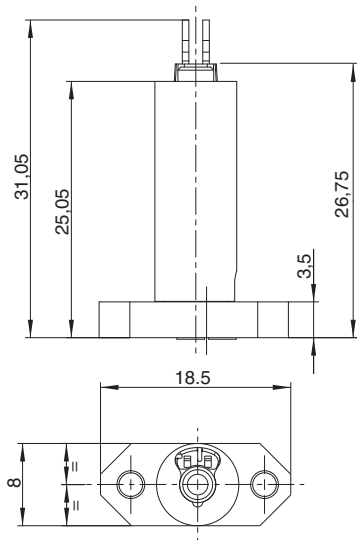
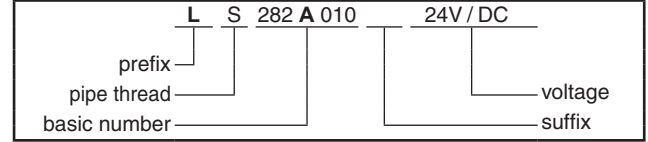

Pad-mounting pattern

