

FEATURES

- Pilot box intended for use in potentially explosive dusty atmospheres, according to Directive ATEX 94/9/EC
- Compliance with the Essential Health and Safety Requirements has been assured by European Standards EN 50014, EN 50281-1-1 and EN 13463-1
- Containing 2 to 12 valves, 2/2 normally closed, direct operated
- Common exhaust connection for 1 or 2 (G 3/8") silencers
- Degree of protection: IP65
- Facilities for integrated quick fittings
- The components satisfy all relevant EC directives

GENERAL

Differential pressure (PS) 0 to 8,5 bar [1 bar = 100kPa]
Response times 5 - 25 ms

| fluid | temperature range (TS) | seal material |
|-------|------------------------|---------------|
| air | -20 to +80°C | NBR (nitrile) |

CONSTRUCTION

| | |
|------------------------------|-------------------------------|
| Base-plate | Anodised aluminium |
| Cover | Aluminium |
| Core tube | Brass |
| Core and plugnut | Stainless steel |
| Spring | Stainless steel |
| Disc | NBR (nitrile) |
| Shading coil | Copper |
| Coil insulation class | F |
| Electrical connection | Spades according to DIN 46244 |

ELECTRICAL CHARACTERISTICS

Standard voltages DC (=) 24V; AC (~) 24V - 115V - 230V/50Hz

| coil type | nominal power ratings | | | | ambient temperature range (2) (°C) | protection |
|--------------|-----------------------|-----------|----------|----------|---------------------------------------|------------|
| | inrush | holding | | cold | | |
| | ~ (VA) | ~ (VA) | ~ (W) | = (W) | | |
| UCM22-FI (1) | 20,4 | 14 | 10 | 22 | -40 to +75 | moulded |

TEMPERATURE CLASSIFICATION TABLES

AC (~) Solenoids

| power level (watt) | isolation class | maximum ambient °C surface temperature | | |
|--------------------|-----------------|--|-------|-------|
| | | 85°C | 100°C | 135°C |
| | | 10,0 | F | 40°C |

DC (=) Solenoids

| power level (watt) | isolation class | maximum ambient °C surface temperature | | |
|--------------------|-----------------|--|-------|-------|
| | | 85°C | 100°C | 135°C |
| | | 22,0 | F | 40°C |

SPECIFICATIONS

| number of pilot valves | pipe size | orifice size | flow coefficient Kv | | operating pressure differential (bar) | | catalogue number for ATEX approved boxes (2) | | |
|------------------------|----------------|----------------|---------------------|-----|---------------------------------------|--------------|--|-----------------------|------------------------|
| | | | | | min. | maximum (PS) | without heating | 1 heating element (3) | 2 heating elements (3) |
| | | | | | | air | | | |
| 2 | 1/8 | 3,6 | 0,35 | 5,8 | 0 | 8,5 | WPSDU G110A020 | WPSDU G110A021 | - |
| 3 | | | | | | | WPSDU G110A030 | WPSDU G110A031 | - |
| 4 | | | | | | | WPSDU G110A040 | WPSDU G110A041 | - |
| 5 | | | | | | | WPSDU G110A050 | WPSDU G110A051 | - |
| 6 | | | | | | | WPSDU G110A060 | WPSDU G110A061 | - |
| 7 | | | | | | | 1/8 | 3,6 | 0,35 |
| 8 | WPSDU G110A080 | WPSDU G110A081 | WPSDU G110A082 | | | | | | |
| 9 | WPSDU G110A090 | WPSDU G110A091 | WPSDU G110A092 | | | | | | |
| 10 | WPSDU G110A100 | WPSDU G110A101 | WPSDU G110A102 | | | | | | |
| 11 | WPSDU G110A110 | WPSDU G110A111 | WPSDU G110A112 | | | | | | |
| 12 | WPSDU G110A120 | WPSDU G110A121 | WPSDU G110A122 | | | | | | |

(1) Intermittent duty, Relative Duty Time is 10%. Max on time is 1 min.

(3) Heating element(s) 220-240 VDC / VAC 50-60 Hz standard, for other voltages see ordering information. Heating element(s) rating 80 watt each.

(2) Minimum ambient temperature without heating elements: 0°C

Minimum ambient temperature with 1 heating element : -40°C (2 to 6 pilots)
: -15°C (7 to 12 pilots)

Minimum ambient temperature with 2 heating elements : -40°C (7 to 12 pilots)

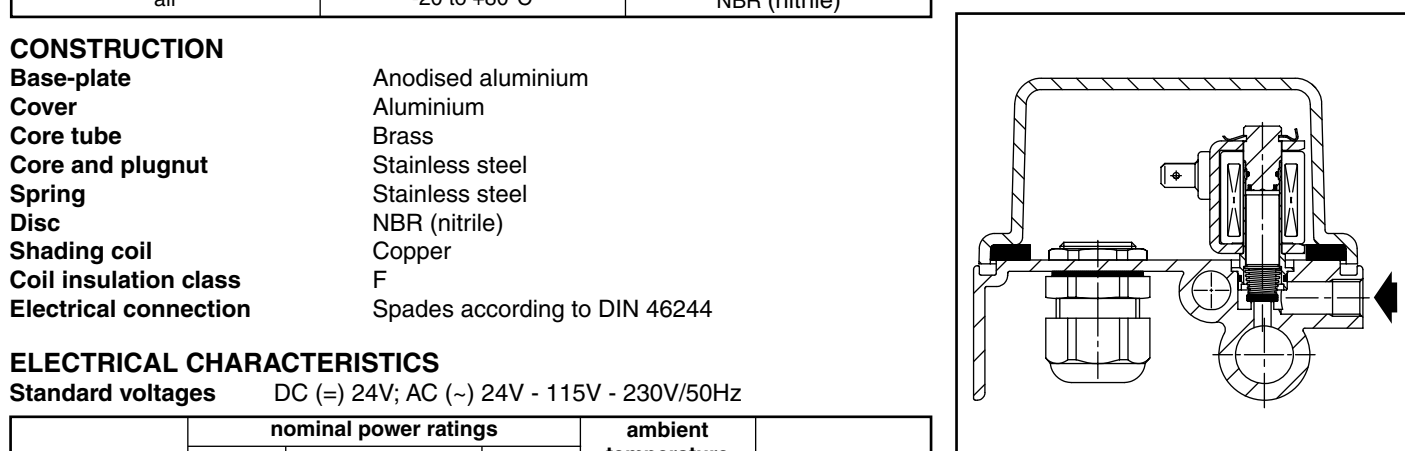
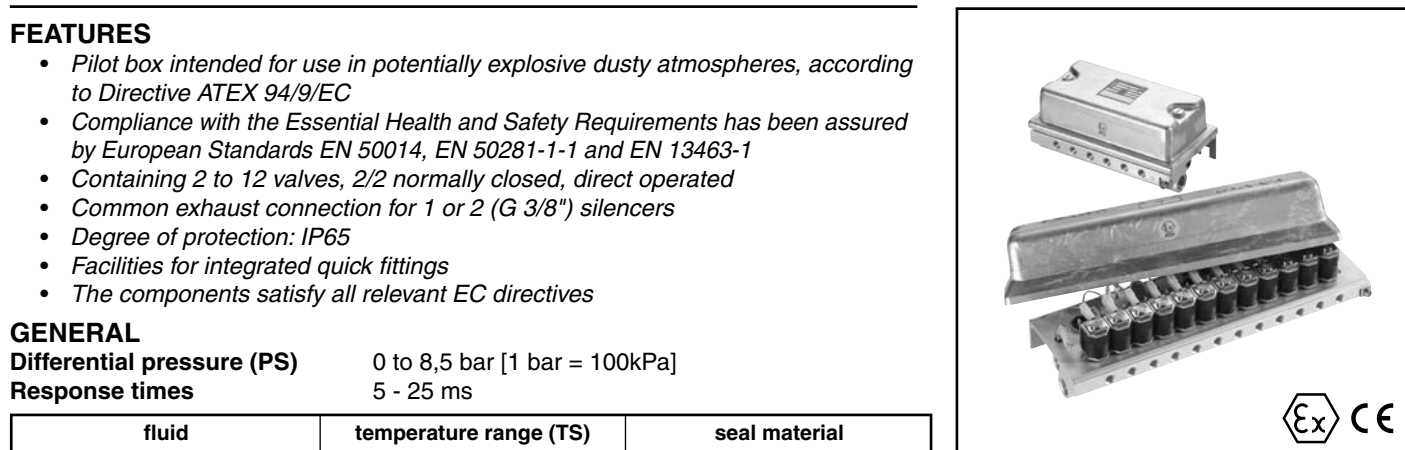

OPTIONS

- Integrated quick fittings for 6 or 8 mm tubes
- Special customer adapted executions

INSTALLATION

- The pilot boxes can be mounted in any position without affecting operation
- Pipe connections are: G 1/8 according to ISO 228 for pilot connection
G 3/8 according to ISO 228 for common exhaust
- Cable entries: control cable on box with 2-6 pilot valves : cable Ø 7 - 12 mm
control cable on box with 7-12 pilot valves : cable Ø 9 - 16 mm
connection cable heating element : cable Ø 5 - 10 mm
- Installation/maintenance instructions are included with each pilot box
- Spare parts kit and replacement coils are available

DIMENSIONS (mm), WEIGHT (kg)

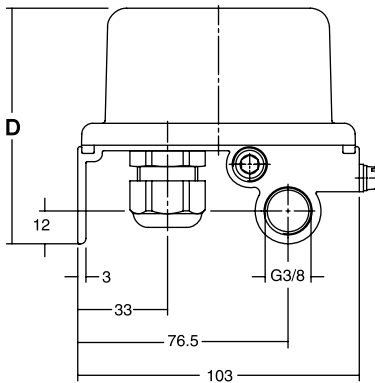
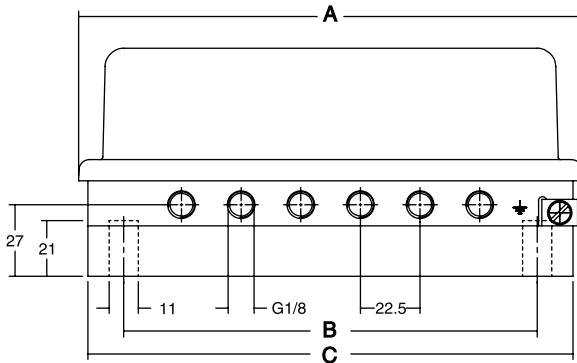

ORDERING INFORMATION

WP S DU G110 A 12 0 230/50

Volts/ Hz

Optional execution

- 0 = no heating element
- 1 = 1 heating element 230V/50Hz
- 2 = 2 heating elements 230V/50Hz
- 3 = 1 heating element 24V DC
- 4 = 2 heating elements 24V DC
- 5 = 1 heating element 115V/50Hz
- 6 = 2 heating elements 115V/50Hz

Number of pilots

- 02 = 2 pilot valves
- 03 = 3 pilot valves etc. (max. 12)

Change letter

Basic number

- G110 = threaded ports
- G120 = 6 mm quick fitting + TPL 22467
- G130 = 8 mm quick fitting + TPL 22386

Approval according to
Directive ATEX 94/9/EC

Electrical connection
spade terminals 6,3 x 0,8

Prefix (optional)

WP: Waterproof IP 65
metal enclosure and cover

| number of pilot valves | A | B | C | D |
|------------------------|-----|-----|-----|----|
| 2 to 6 | 190 | 156 | 183 | 86 |
| 7 to 12 | 328 | 266 | 318 | 95 |